

# XP

## PASSTHROUGH DISHWASHER

# WASHTECH®



### STANDARD FEATURES

- 1, 2 and 3 minute dishwashing cycles
- 2.2L per cycle water consumption
- Compatible with 500mm racks
- Washes up to 1,080 dishes per hour
- Adjustable benchgap of 595mm to 640mm
- Washtech hybrid controls
- Easy change to higher power / rapid rinse recovery mode
- Hands-free auto-drain with drain pump
- 1.0HP wash pump and dual chemical pumps
- Heavy duty stainless steel wash manifold and scrap trays
- Stainless steel wash and drain filter

### Includes

- 1x 500mm dish rack (600 70028)
- 1x 500mm cup rack (600 70029)
- 1x cutlery container (C660503)
- Quick connection kit (all hoses and 15A plugset)

### SPECIFICATIONS

#### A - Hot Water

Temperature	65°C
Connection	3/4" male, hose supplied
Pressure	200-350kPa
Flow	20L per minute
Backflow prevention	Atmospheric vacuum breaker
Consumption	2.2L per cycle*

#### D - Drainage

Drain pump flexi-hose	25mm
-----------------------	------

#### C - Electrical

	V	Hz	A/ph	Max kW
Single phase	230-240	50	15	3.25
Single phase	230-240	50	25	5.75
Three phase	400-415	50	15	7.50

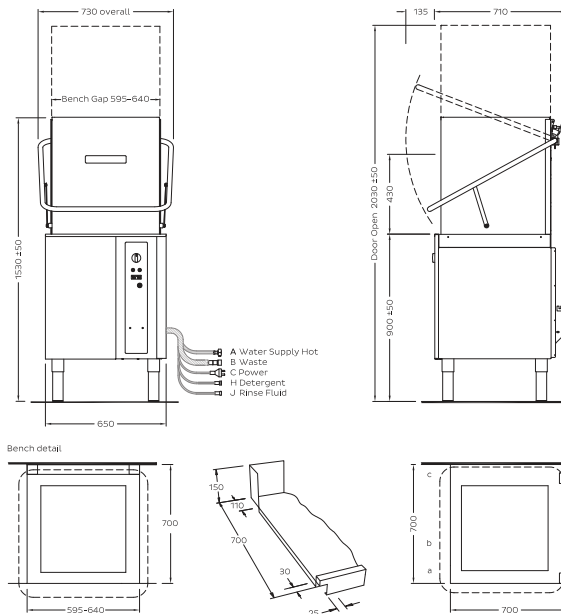

#### Dimensions

	Machine	Packed
Width (mm)	730	760
Depth (mm)	710	820
Height (mm)	1530	1460
Weight (kg)	94	125
Volume (m3)		0.91

#### Water Quality

	Min	Max
pH	7	8
TDS	1	135
Cl-		100
SO4		400
Fe		0.1
Mn		0.5
Cu		0.05
Cl2		0.1

\*Water consumption rates may vary based on site conditions  
Isolating switch must be within 1m of, and not directly behind, the machine  
Refer to operator manual for installation instructions

In line with policy to continually develop and improve its products, Washtech reserves the right to change specifications and design without notice.

Corner installation: machine must face left for access to controls; allow 300mm front clearance for service access; and splashback return <150mm.  
Inline installation: front panels can be adjusted to 605mm leaving upper 80mm sill only at 650mm; for sites requiring full cabinet <650mm, order WXP0031.



moffat.com.au | 1300 269 801

Manufactured in New Zealand by Washtech Limited - Distributed in Australia by Moffat PTY Limited  
© Copyright Washtech Limited / Washtech XP Series-4 / WXP0040 / Apr-24

an Ali Group Company



the spirit of excellence